

Emergency Modular Hospital

25 beds

The system can be adapted to different scenarios and situations. Emergency hospital includes triage, 6 expectation beds, operating theater, 4 ICU beds, 10 one-day surgery beds, laboratories, RTG device and examinations.



Emergency Modular Hospital

25 beds

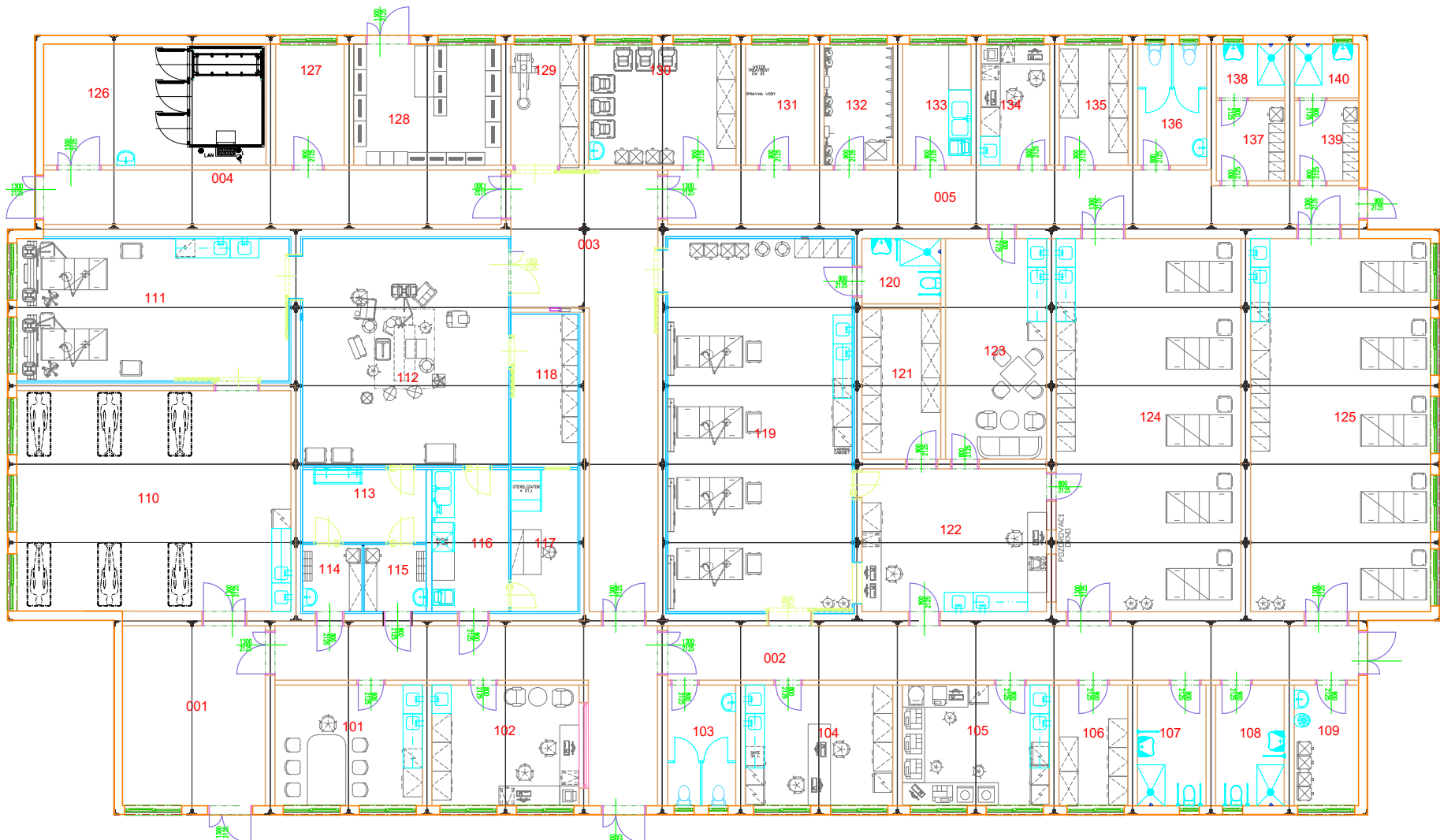

BLOCK[®]
Health Technology Solutions

www.blockhts.cz